



MIRACLES OF HIGH FIDELITY

400.903

# RICAMBI *SPARE PARTS*

**Dischi Freno  
Pastiglie e Segnalatori Usura Freni**

***Brake Discs / Brake Pads  
Brake Wear Sensors***

Gamma / Range

# VOLVO

Date

04/2010

File

RIFRO90.Pdf

# CEI

HIGH FIDELITY SPARE PARTS

CEI no.  
**215.026**

O.E.M. Ref  
6779208  
6779205  
67792085

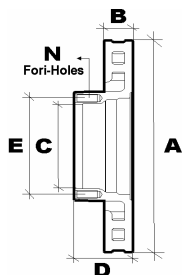

**Misure / Sizes**

<b>A</b>	<b>322 mm</b>
<b>B</b>	<b>30 mm</b>
<b>C</b>	<b>132 mm</b>
<b>D</b>	<b>90 mm</b>
<b>E</b>	<b>154 mm</b>
<b>N</b>	<b>6</b>



CEI no.  
**584.089**

O.E.M. Ref  
2761476  
3090048



**WVA 29039 29302 21302**

**Misure / Sizes 175,5 x 78 x 22**

**Impianto / Equipment :**

**Quantità / Qty 4**

**Anter./ Front**

**Models FL**  
FL4 - FLC

CEI no.  
**215.027**

O.E.M. Ref  
6779209  
67792093

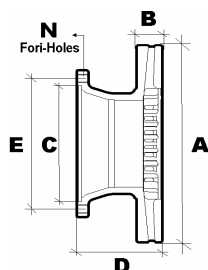

**Misure / Sizes**

<b>A</b>	<b>322 mm</b>
<b>B</b>	<b>30 mm</b>
<b>C</b>	<b>164 mm</b>
<b>D</b>	<b>115 mm</b>
<b>E</b>	<b>190 mm</b>
<b>N</b>	<b>6</b>



CEI no.  
**584.089**

O.E.M. Ref  
2761476  
3090048



**WVA 29039 29302 21302**

**Misure / Sizes 175,5 x 78 x 22**

**Impianto / Equipment :**

**Quantità / Qty 4**

**Post./Rear**

**Models FL**  
FL4 - FLC

All original equipment manufacturer's numbers, symbols, pictures, models and description used in this catalogue are for reference only, and it is not implied that any part listed is the product of these manufacturers. Tutti i nostri particolari non sono originali ma con essi intercambiabili. I riferimenti originali, le figure, i modelli sono esposti a semplice titolo indicativo. La nostra produzione riporta il nostro marchio.

CEI no.  
**215.209**  
O.E.M. Ref  
3095652

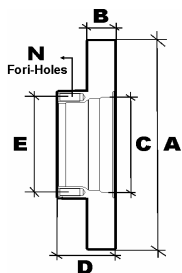

<b>Misure / Sizes</b>	
<b>A</b>	<b>336,5 mm</b>
<b>B</b>	<b>30 mm</b>
<b>C</b>	<b>146 mm</b>
<b>D</b>	<b>100,5 mm</b>
<b>E</b>	<b>120 mm</b>
<b>N</b>	<b>10+2</b>



CEI no.  
**584.037**  
O.E.M. Ref  
3093531

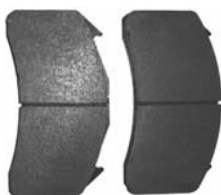

<b>WVA</b>	<b>29136</b>
<b>Misure / Sizes</b>	<b>175,7 x 89,1 x 29,2</b>
<b>Impianto / Equipment :</b>	<b>MERITOR</b>
<b>Quantità / Qty</b>	<b>4</b>

**Anter./ Front**

**Models FL**  
FL6

CEI no.  
**215.210**  
O.E.M. Ref  
3095672

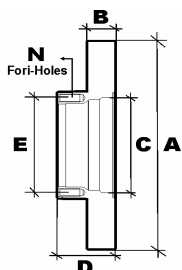

<b>Misure / Sizes</b>	
<b>A</b>	<b>375 mm</b>
<b>B</b>	<b>45 mm</b>
<b>C</b>	<b>168 mm</b>
<b>D</b>	<b>130 mm</b>
<b>E</b>	<b>138 mm</b>
<b>N</b>	<b>14+2</b>



CEI no.  
**584.036**  
O.E.M. Ref  
20768115  
3093532



<b>WVA</b>	<b>29137</b>
<b>Misure / Sizes</b>	<b>210,1 x 102,4 x 29,2</b>
<b>Impianto / Equipment :</b>	<b>MERITOR</b>
<b>Quantità / Qty</b>	<b>4</b>

**Anter./ Front**

**Models FL**  
FL6

CEI no.  
**215.133**

O.E.M. Ref  
3095632

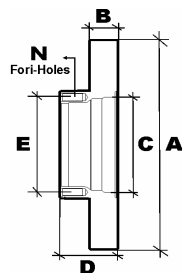

**Misure / Sizes**

A	336,5 mm
B	30 mm
C	147,5 mm
D	100,5 mm
E	120 mm
N	10



CEI no.  
**584.037**

O.E.M. Ref  
3093531



**WVA 29136**

<b>Misure / Sizes</b>	175,7 x 89,1 x 29,2
<b>Impianto / Equipment :</b>	<b>MERITOR</b>
<b>Quantità / Qty</b>	4

**Post./Rear**

**Models FL**  
FL6 - BRAKE DV TYPE "L"

CEI no.  
**215.132**

O.E.M. Ref  
3095673

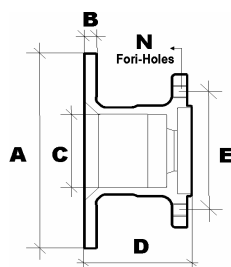

**Misure / Sizes**

A	336,5 mm
B	30 mm
C	215,2 mm
D	143 mm
E	275,5 mm
N	8



CEI no.  
**584.036**

O.E.M. Ref  
3093532  
20768115



**WVA 29137**

<b>Misure / Sizes</b>	210,1 x 102,4 x 29,2
<b>Impianto / Equipment :</b>	<b>MERITOR</b>
<b>Quantità / Qty</b>	4

**Post./Rear**

**Models FL**  
FL6 - BRAKE DV TYPE "H"

CEI no.  
**215.001**

O.E.M. Ref  
6774687  
6774686

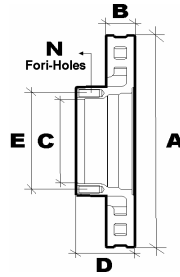

**Misure / Sizes**

A	322 mm
B	30 mm
C	132 mm
D	90 mm
E	154 mm
N	8



CEI no.  
584.089

O.E.M. Ref  
2761476  
3090048



<b>WVA</b>	<b>29039</b>	<b>29302</b>	<b>21302</b>
<b>Misure / Sizes</b>	175,5 x 78 x 22		
<b>Impianto / Equipment :</b>	<b>MERITOR</b>		
<b>Quantità / Qty</b>	4		

**Models FL**

FL6  
FL6.08 - FL6.15

**Anter./ Front**

CEI no.  
**215.025**

O.E.M. Ref  
6775227  
6775229  
6775223

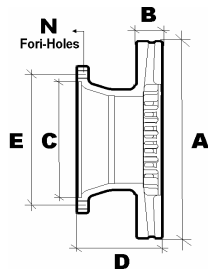

**Misure / Sizes**

A	322 mm
B	30 mm
C	216 mm
D	138 mm
E	275 mm
N	8



CEI no.  
584.089

O.E.M. Ref  
2761476  
3090048



<b>WVA</b>	<b>29039</b>	<b>29302</b>	<b>21302</b>
<b>Misure / Sizes</b>	175,5 x 78 x 22		
<b>Impianto / Equipment :</b>	<b>MERITOR</b>		
<b>Quantità / Qty</b>	4		

**Models FL**

FL6  
FL6.08 - FL6.15

**Post./Rear**

All original equipment manufacturers numbers, symbols, pictures and description used in this catalogue are for reference only, and it is not implied that any part listed is the product of these manufactures. Tutti i nostri particolari non sono originali ma con essi intercambiabili. I riferimenti originali, le figure, i modelli sono esposti a semplice titolo indicativo. La nostra produzione riporta il nostro marchio.

CEI no.  
**215.174**

O.E.M. Ref  
6796864

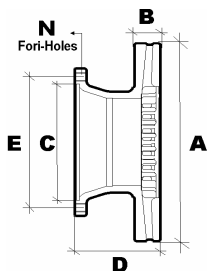

**Misure / Sizes**

A	322 mm
B	30 mm
C	216 mm
D	138 mm
E	274,5 mm
N	8



CEI no.  
**584.089**

O.E.M. Ref  
2761476  
3090048



<b>WVA</b>	<b>29039</b>	<b>29302</b>	<b>21302</b>
<b>Misure / Sizes</b>	175,5 x 78 x 22		
<b>Impianto / Equipment :</b>	<b>MERITOR</b>		
<b>Quantità / Qty</b>	4		

**Models FL**

FL6  
FL6.08 - FL6.15

**Post./Rear**

CEI no.

O.E.M. Ref  
85103809

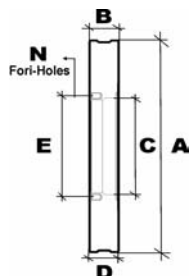

**Misure / Sizes**

A	375,5 mm
B	45 mm
C	181,1 mm
D	45
E	
N	6



CEI no.  
**584.036**

O.E.M. Ref  
3093532  
20768115



<b>WVA</b>	<b>29137</b>
<b>Misure / Sizes</b>	210,1 x 102,4 x 29,2
<b>Impianto / Equipment :</b>	<b>MERITOR</b>
<b>Quantità / Qty</b>	4

**Models FH - FM**

FM9 - FM12 - FH12 - FH16  
Diametro / Diameter 370 mm (Non ventilato / Not vented)

**Anter e Post**  
**Front and Rear**

All original equipment manufacturer's numbers, symbols, pictures, models and description used in this catalogue are for reference only, and it is not implied that any part listed is the product of these manufactures. Tutti i nostri particolari non sono originali ma con essi intercambiabili. I riferimenti originali, le figure, i modelli sono esposti a semplice titolo indicativo. La nostra produzione riporta il nostro marchio.

CEI no.

O.E.M. Ref  
85103805

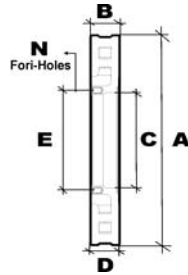

Misure / Sizes

A	375 mm
B	45 mm
C	200 mm
D	45 mm
E	
N	6



CEI no.

**584.036**

O.E.M. Ref  
3093532  
20768115



**WVA 29137**

Misure / Sizes	210,1 x 102,4 x 29,2
Impianto / Equipment :	<b>MERITOR</b>
Quantità / Qty	4

**Models FH - FM**

FM9 - FM12 - FH12 - FH16

Diametro / Diameter 370 mm (Ventilato / Vented)

**Anter e Post**  
**Front and Rear**

CEI no.

O.E.M. Ref  
85103806

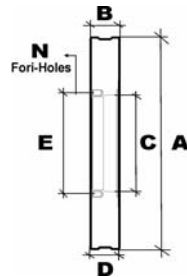

Misure / Sizes

A	410 mm
B	45 mm
C	220,2 mm
D	45 mm
E	
N	8



CEI no.

**584.047**

O.E.M. Ref  
20568715  
20568712

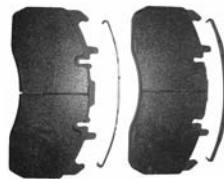

**WVA 29173 29203**

Misure / Sizes	216,2 x 97 x 29,2
Impianto / Equipment :	<b>MERITOR</b>
Quantità / Qty	4

CEI no.

**584.049**

O.E.M. Ref  
20768101  
3099533



**WVA 29151**

Misure / Sizes	216,1 x 97,1 x 29,2
Impianto / Equipment :	<b>MERITOR</b>
Quantità / Qty	4

**Models FH - FM**

FM9 - FM12 - FH12 - FH16

Diametro / Diameter 410 mm (Non ventilato / Not vented)

**Anter e Post**  
**Front and Rear**

CEI no.

O.E.M. Ref  
85110495  
85103804

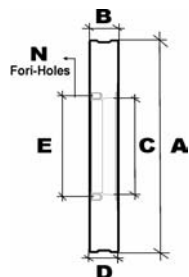

*Misure / Sizes*

<b>A</b>	<b>409,5 mm</b>
<b>B</b>	<b>45 mm</b>
<b>C</b>	<b>224 mm</b>
<b>D</b>	<b>45 mm</b>
<b>E</b>	
<b>N</b>	<b>6</b>



CEI no.

**584.047**

O.E.M. Ref  
20568715  
20568712

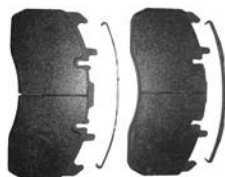

**WVA 29173 29203**

*Misure / Sizes* **216,2 x 97 x 29,2**

*Impianto / Equipment* : **MERITOR**

*Quantità / Qty* **4**

CEI no.

**584.049**

O.E.M. Ref  
20768101  
3099533



**WVA 29151**

*Misure / Sizes* **216,1 x 97,1 x 29,2**

*Impianto / Equipment* : **MERITOR**

*Quantità / Qty* **4**

**Anter e Post**  
**Front and Rear**

**Models FH - FM**

FM9 - FM12 - FH12 - FH16

Diametro / Diameter 410 mm (Ventilato / Vented)

All original equipment manufacturer's numbers, symbols, pictures, models and description used in this catalogue are for reference only, and it is not implied that any part listed is the product of these manufacturers.  
Tutti i nostri particolari non sono originali ma con essi intercambiabili. I riferimenti originali, le figure, i modelli sono esposti a semplice titolo indicativo. La nostra produzione riporta il nostro marchio.



CEI no.

O.E.M. Ref  
3092710

CEI no.

**584.026**

O.E.M. Ref  
20768092  
20918891

**Anter e Post**  
**Front and Rear**

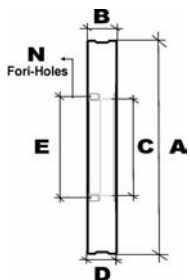

*Misure / Sizes*

A	434 mm
B	45 mm
C	220 mm
D	45 mm
E	
N	8



**WVA 29125**

*Misure / Sizes* 249 x 110,9 x 29,5  
*Impianto / Equipment :* **LUCAS/MERITOR**  
*Quantità / Qty* **4+MOLLE / SPRINGS**

**Models FH - FM**

FL6 - FM7 - FM9 - FM10 - FM12 - FH12 - FH16 Bus B7R - B12  
Diametro / Diameter 430 mm (Non ventilato / Not Vented)

CEI no.

O.E.M. Ref  
85103803

CEI no.

**584.026**

O.E.M. Ref  
20768092  
20918891

**Anter./ Front**

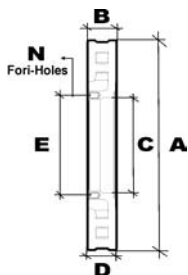

*Misure / Sizes*

A	434 mm
B	45 mm
C	220 mm
D	45 mm
E	
N	8



**WVA 29125**

*Misure / Sizes* 249 x 110,9 x 29,5  
*Impianto / Equipment :* **LUCAS/MERITOR**  
*Quantità / Qty* **4+MOLLE / SPRINGS**

**Models FH - FM**

FM9 - FM12 - FH12 - FH16  
Diametro / Diameter 430 mm (Ventilato / Vented)

CEI no.

**215.173**

O.E.M. Ref  
3112965  
31129650

CEI no.

**584.024**

O.E.M. Ref  
20825594  
85105485

**Anter./ Front**

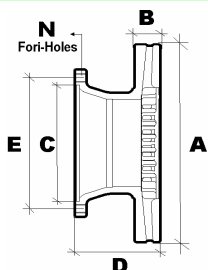

*Misure / Sizes*

A	438 mm
B	45 mm
C	195 mm
D	127 mm
E	235 mm
N	10



**WVA 29090**

*Misure / Sizes* 249 x 114,4 x 28  
*Impianto / Equipment :* **GIRLING**  
*Quantità / Qty* **4+KIT**

**Models BUS**

BUS BL10 - B12

All original equipment manufacturers numbers, symbols, pictures, models and description used in this catalogue are for reference only, and it is not implied that any part listed is the product of these manufacturers. Tutti i nostri particolari non sono originali ma con essi intercambiabili. I riferimenti originali, le figure, i modelli sono esposti a semplice titolo indicativo. La nostra produzione riporta il nostro marchio.