



MIRACLES OF HIGH FIDELITY

400.903

# RICAMBI *SPARE PARTS*

**Dischi Freno  
Pastiglie e Segnalatori Usura Freni**

***Brake Discs / Brake Pads  
Brake Wear Sensors***

Gamma / Range

# RENAULT V.I.

Date

04/2010

File

RIFRO75.Pdf

# CEI

HIGH FIDELITY SPARE PARTS

# Freni Brakes

1

Suitable To : **RENAULT V.I.**

CEI no.

**215.014**

O.E.M. Ref  
50 00 396 612

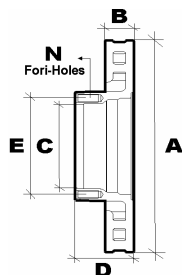

Misure / Sizes

A	276 mm
B	24 mm
C	95 mm
D	44 mm
E	114 mm
N	10



CEI no.

**584.082**

O.E.M. Ref  
50 00 295 329  
50 01 834 527

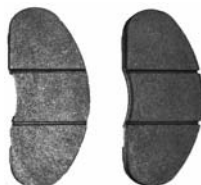

**WVA 20706 20707**

Misure / Sizes 166,5 x 62 x 17  
Impianto / Equipment : **ABEX**  
Quantità / Qty 2

CEI no.

**583.031**

O.E.M. Ref  
50 01 822 897/S



Lunghezza / Length L=580 mm  
Conettore / Connector **OVALE/OVAL**  
Impianto / Equipment : **GIRLING**  
Quantità / Qty 2

**Anter./ Front  
1a GEN. / 1st GEN**

**Models Old Generation**

J35 - J48 - J55 - J60 - B70 - B80 - B90 - B110 - B120

CEI no.

**215.048**

O.E.M. Ref  
50 10 216 433

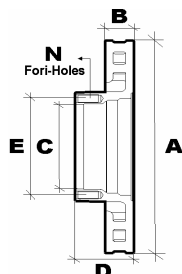

Misure / Sizes

A	276 mm
B	24 mm
C	102 mm
D	44 mm
E	120 mm
N	10



CEI no.

**584.082**

O.E.M. Ref  
50 00 295 329  
50 01 834 527

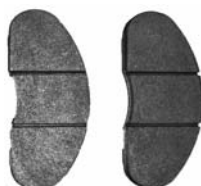

**WVA 20706 20707**

Misure / Sizes 166,7 x 61,6 x 17  
Impianto / Equipment : **ABEX**  
Quantità / Qty 2

CEI no.

**583.031**

O.E.M. Ref  
50 01 822 897/S



Lunghezza / Length L=580 mm  
Conettore / Connector **OVALE/OVAL**  
Impianto / Equipment : **GIRLING**  
Quantità / Qty 2

**Anter./ Front  
2a GEN. / 2nd GEN**

**Models Old Generation**

B70 - B80 - B90 - B110 - B120

All original equipment manufacturer's numbers, symbols, pictures, models and description used in this catalogue are for reference only, and it is not implied that any part listed is the product of these manufacturers. Tutti i nostri particolari non sono originali ma con essi intercambiabili. I riferimenti originali, le figure, i modelli sono esposti a semplice titolo indicativo. La nostra produzione riporta il nostro marchio.

CEI no.

**215.049**

O.E.M. Ref  
50 10 260 604

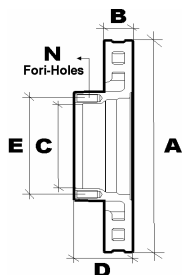

*Misure / Sizes*

A	290 mm
B	22 mm
C	102 mm
D	42,50 mm
E	120 mm
N	10



CEI no.

**584.014**

O.E.M. Ref  
50 01 844 747  
50 01 850 859



**WVA 29121 29374 29357**

*Misure / Sizes* 164,8 x 66,5 x 20,3

*Impianto / Equipment* : **BREMBO**

*Quantità / Qty* 4

**Models Mascott**

Da 3,5 Ton a 5 Ton / From 3,5 Ton To 5 Ton

**Anter./ Front**

CEI no.

**215.050**

O.E.M. Ref  
50 10 260 603

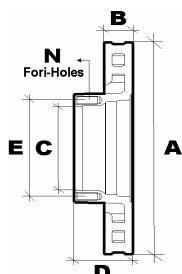

*Misure / Sizes*

A	290 mm
B	26 mm
C	102 mm
D	42 mm
E	120 mm
N	10



CEI no.

**584.009**

O.E.M. Ref  
50 01 844 748



**WVA 29160 29161**

*Misure / Sizes* 164,6 x 68 x 20

*Impianto / Equipment* : **BREMBO**

*Quantità / Qty* 4

**Models Mascott**

Da 5,5 Ton a 6,5 Ton / From 5,5 Ton To 6,5 Ton

**Anter./ Front**

CEI no.

**215.051**

O.E.M. Ref  
50 10 260 609

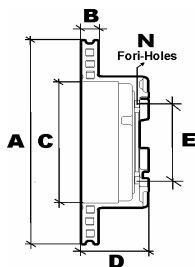

*Misure / Sizes*

A	290 mm
B	22 mm
C	115 mm
D	78 mm
E	132 mm
N	8



CEI no.

**584.014**

O.E.M. Ref  
50 01 844 747  
50 01 850 859



**WVA 29121 29374 29357**

*Misure / Sizes* 164,8 x 66,5 x 20,3

*Impianto / Equipment :* **BREMBO**

*Quantità / Qty* 4

**Post./Rear**

**Models Mascott**

Da 3,5 Ton a 9 Ton / From 3,5 Ton To 9 Ton

CEI no.

**215.038**

O.E.M. Ref  
50 10 260 101  
50 10 216 931

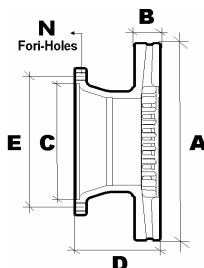

*Misure / Sizes*

A	304 mm
B	30 mm
C	250 mm
D	135 mm
E	205 mm
N	6



CEI no.

**584.083**

O.E.M. Ref  
50 01 873 217



**WVA**

*Misure / Sizes* 174,5 x 85,5 x 21,5

*Impianto / Equipment :*

*Quantità / Qty* 4

**Anter./ Front**

**Models MIS Series**

M/S 120-135-140-150-160-180-210-220-230-250 - MIDLINER (GB)

Assale / Axle **E402**

CEI no.

**215.039**

O.E.M. Ref  
50 10 260 102  
50 10 216 932

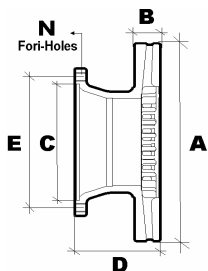

*Misure / Sizes*

A	322 mm
B	30 mm
C	290 mm
D	140 mm
E	245 mm
N	6



CEI no.

**584.084**

O.E.M. Ref  
50 01 873 218



**WVA**

<i>Misure / Sizes</i>	175,5 x 78 x 22,5
<i>Impianto / Equipment :</i>	
<i>Quantità / Qty</i>	4

**Models MIS Series**

M/S 120-135-140-150-160-180-210-220-230-250 - MIDLINER (GB)

Assale / Axle **E401**

**Anter./ Front**

CEI no.

**189.525**

O.E.M. Ref  
50 00 450 158  
50 00 545 242

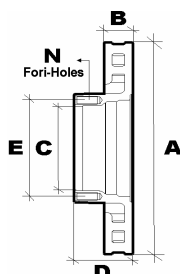

*Misure / Sizes*

A	354 mm
B	30 mm
C	128 mm
D	82 mm
E	151 mm
N	10



CEI no.

**584.085**

O.E.M. Ref  
50 01 821 995  
50 00 297 808



**WVA 29013**

<i>Misure / Sizes</i>	180 x 86 x 20,5
<i>Impianto / Equipment :</i>	
<i>Quantità / Qty</i>	4

**Models JIP - MIS Series**

JE13 -JE15 / PS150 - PS160 - PA200 - PA210

M/S 130-140-150-160-180-210-220-230-250 - MIDLINER (GB)

Assale / Axle **E400**

**Anter./ Front**

CEI no.

**215.084**

O.E.M. Ref  
50 10 260 218

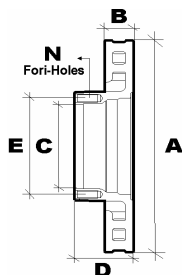

*Misure / Sizes*

A	380 mm
B	45 mm
C	117 mm
D	85 mm
E	144 mm
N	10



CEI no.

**584.042**

O.E.M. Ref  
50 01 833 104  
50 01 857 615

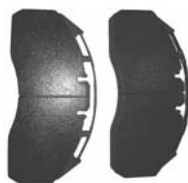

**WVA 29100**

<i>Misure / Sizes</i>	213,84 x 111,7 x 25
<i>Impianto / Equipment :</i>	<b>MERITOR</b>
<i>Quantità / Qty</i>	4 + MOLLE / SPRINGS

CEI no.

**584.057**

O.E.M. Ref

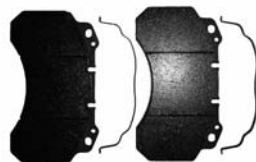

**WVA 29099**

<i>Misure / Sizes</i>	214 x 112 x 25
<i>Impianto / Equipment :</i>	<b>MERITOR</b>
<i>Quantità / Qty</i>	4

**Models MIS Series**

M/S 150-180-210-220-230-250 / PA200 - PA210 / MIDLUM

Assale / Axle **E62**

**Anter./ Front**

CEI no.

**215.116**

O.E.M. Ref  
50 10 422 262

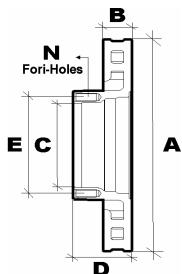

*Misure / Sizes*

A	330 mm
B	34 mm
C	95 mm
D	80 mm
E	120 mm
N	10



CEI no.

**584.028**

O.E.M. Ref  
50 10 848 607



**WVA 29088 29091**

<i>Misure / Sizes</i>	175,5 x 85,5 x 26
<i>Impianto / Equipment :</i>	<b>WABCO</b>
<i>Quantità / Qty</i>	4 + MOLLE / SPRINGS

**Anter./ Front**

**Models MIDLUM**

CEI no.

**215.085**

O.E.M. Ref  
50 10 525 014

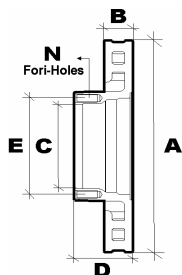

*Misure / Sizes*

A	375 mm
B	45 mm
C	117 mm
D	99 mm
E	145 mm
N	10



CEI no.

**584.051**

O.E.M. Ref  
50 01 855 902



<b>WVA</b>	<b>29141</b>	<b>29142</b>	<b>29119</b>
<i>Misure / Sizes</i>	204,6 x 99,6 x 30		
<i>Impianto / Equipment :</i>	<b>WABCO</b>		
<i>Quantità / Qty</i>	4		

**Anter./ Front**

**Models MIDLUM**

CEI no.

**215.086**

O.E.M. Ref  
50 10 598 303  
50 10 525 308

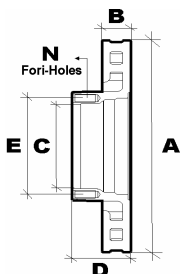

*Misure / Sizes*

A	330 mm
B	34 mm
C	95 mm
D	80 mm
E	118 mm
N	10+2



CEI no.

**584.028**

O.E.M. Ref  
50 10 848 607



<b>WVA</b>	<b>29088</b>	<b>29091</b>
<i>Misure / Sizes</i>	175,5 x 85,5 x 26	
<i>Impianto / Equipment :</i>	<b>WABCO</b>	
<i>Quantità / Qty</i>	4 + MOLLE / SPRINGS	

**Anter./ Front**

**Models MIDLUM**

CEI no.

215.199

O.E.M. Ref  
50 10 598 305

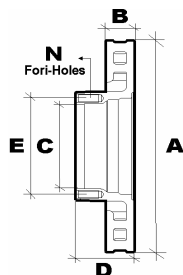

Misure / Sizes

A	375 mm
B	45 mm
C	111 mm
D	119 mm
E	142 mm
N	10+2



CEI no.

584.086

O.E.M. Ref  
50 01 866 914  
50 10 598 372



**WVA 29181**

Misure / Sizes	210,5 x 93,5 x 30
Impianto / Equipment :	<b>HALDEX</b>
Quantità / Qty	4

**Anter./ Front**

**Models MIDLUM Dxi**

CEI no.

215.200

O.E.M. Ref  
50 10 598 308

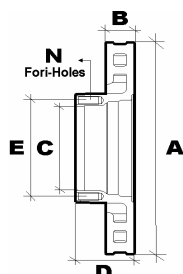

Misure / Sizes

A	410 mm
B	45 mm
C	194 mm
D	93 mm
E	165 mm
N	10+2



CEI no.

584.086

O.E.M. Ref  
50 01 866 914  
50 10 598 372



**WVA 29181**

Misure / Sizes	210,5 x 93,5 x 30
Impianto / Equipment :	<b>HALDEX</b>
Quantità / Qty	4

**Anter./ Front**

**Models MIDLUM Dxi**

All original equipment manufacturer's numbers, symbols, pictures, models and description used in this catalogue are for reference only, and it is not implied that any part listed is the product of these manufactures. Tutti i nostri particolari non sono originali ma con essi intercambiabili. I riferimenti originali, le figure, i modelli sono esposti a semplice titolo indicativo. La nostra produzione riporta il nostro marchio.



CEI no.

**215.101**

O.E.M. Ref  
50 10 422 263

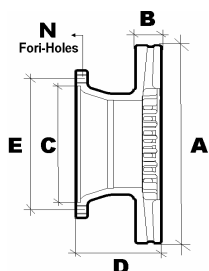

*Misure / Sizes*

A	330 mm
B	34 mm
C	194 mm
D	137 mm
E	245 mm
N	6



CEI no.

**584.028**

O.E.M. Ref  
50 10 848 607



**WVA 29088 29091**

*Misure / Sizes* 175,5 x 85,5 x 26

*Impianto / Equipment :* **WABCO**

*Quantità / Qty* 4 + **MOLLE / SPRINGS**

**Post./Rear**

**Models MIDLUM**

CEI no.

**215.102**

O.E.M. Ref  
50 10 525 362  
50 10 525 015

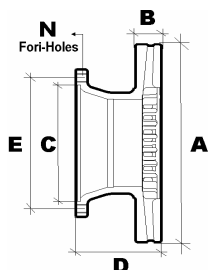

*Misure / Sizes*

A	375 mm
B	45 mm
C	222 mm
D	167 mm
E	275 mm
N	8



CEI no.

**584.051**

O.E.M. Ref  
50 01 855 902



**WVA 29141 29142 29119**

*Misure / Sizes* 204,6 x 99,6 x 30

*Impianto / Equipment :* **WABCO**

*Quantità / Qty* 4

**Post./Rear**

**Models MIDLUM**

CEI no.

215.103

O.E.M. Ref  
50 10 525 363

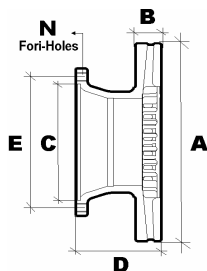

Misure / Sizes

A	375 mm
B	45 mm
C	222,1 mm
D	166,5 mm
E	286 mm
N	10



CEI no.

**584.051**

O.E.M. Ref  
50 01 855 902



**WVA 29141 29142 29119**

Misure / Sizes 204,6 x 99,6 x 30  
Impianto / Equipment : **WABCO**  
Quantità / Qty 4

Post./Rear

Models **MIDLUM**

CEI no.

215.104

O.E.M. Ref  
50 10 525 508

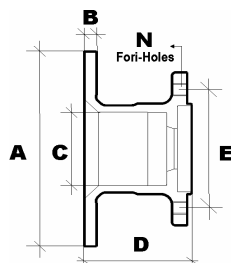

Misure / Sizes

A	433,5 mm
B	45 mm
C	266,5 mm
D	170,5 mm
E	335 mm
N	10



CEI no.

**584.021**

O.E.M. Ref  
50 01 863 904  
50 01 855 646

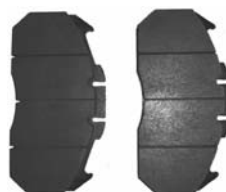

**WVA 29131 29156**

Misure / Sizes 249,3 x 117,9 x 29,8  
Impianto / Equipment : **MERITOR**  
Quantità / Qty 4

Post./Rear

Models **MIDLUM**

CEI no.

**215.162**

O.E.M. Ref  
50 10 525 364

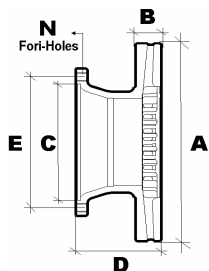

Misure / Sizes

A	375 mm
B	45 mm
C	262 mm
D	167,5 mm
E	335 mm
N	10



CEI no.

**584.087**

O.E.M. Ref  
50 01 863 324

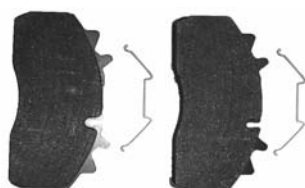

**WVA**

Misure / Sizes	210,5 x 92 x 29,5
Impianto / Equipment :	
Quantità / Qty	4

Post./Rear

Models **MIDLUM 4x4**

CEI no.

**215.201**

O.E.M. Ref  
50 10 598 306

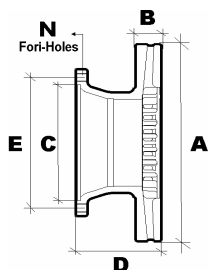

Misure / Sizes

A	375 mm
B	45 mm
C	222 mm
D	166,5 mm
E	275 mm
N	8



CEI no.

**584.086**

O.E.M. Ref  
50 01 866 914  
50 10 598 372



**WVA 29181**

Misure / Sizes	210,5 x 93,5 x 30
Impianto / Equipment :	<b>HALDEX</b>
Quantità / Qty	4

Post./Rear

Models **MIDLUM Dxi**

**CEI no.**

**215.202**

**O.E.M. Ref**

50 10 598 307

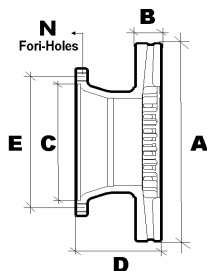

**Misure / Sizes**

<b>A</b>	<b>375 mm</b>
<b>B</b>	<b>45 mm</b>
<b>C</b>	<b>262 mm</b>
<b>D</b>	<b>166,5 mm</b>
<b>E</b>	<b>335 mm</b>
<b>N</b>	<b>10</b>



**CEI no.**

**584.086**

**O.E.M. Ref**

50 01 866 914

50 10 598 372



**WVA 29181**

**Misure / Sizes**

**210,5 x 93,5 x 30**

**Impianto / Equipment :**

**HALDEX**

**Quantità / Qty**

**4**

**Post./Rear**

**Models MIDLUM Dxi**

**CEI no.**

**215.203**

**O.E.M. Ref**

50 10 598 304

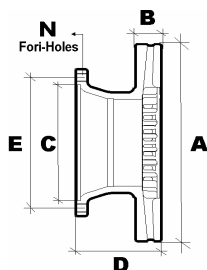

**Misure / Sizes**

<b>A</b>	<b>330 mm</b>
<b>B</b>	<b>34 mm</b>
<b>C</b>	<b>194 mm</b>
<b>D</b>	<b>137 mm</b>
<b>E</b>	<b>245 mm</b>
<b>N</b>	<b>6</b>



**CEI no.**

**584.028**

**O.E.M. Ref**

50 10 848 607



**WVA 29088**

**29091**

**Misure / Sizes**

**175,5 x 85,5 x 26**

**Impianto / Equipment :**

**WABCO**

**Quantità / Qty**

**4 + MOLLE / SPRINGS**

**Post./Rear**

**Models MIDLUM Dxi**

CEI no.

215.208

O.E.M. Ref  
50 10 598 309

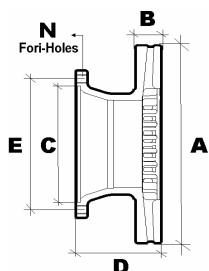

Misure / Sizes

A	410 mm
B	45 mm
C	262 mm
D	166,5 mm
E	335 mm
N	10



CEI no.

**584.047**

O.E.M. Ref  
50 01 864 365

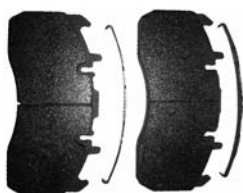

**WVA 29173 29203**

Misure / Sizes	216,2 x 97 x 29,2
Impianto / Equipment :	<b>MERITOR</b>
Quantità / Qty	4

Post./Rear

Models **MIDLUM Dxi**

CEI no.

215.201

O.E.M. Ref  
50 10 598 306

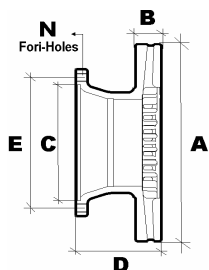

Misure / Sizes

A	375 mm
B	45 mm
C	222 mm
D	166,5 mm
E	275 mm
N	8



CEI no.

584.086

O.E.M. Ref  
50 01 866 914  
50 10 598 372



**WVA 29181**

Misure / Sizes	210,5 x 93,5 x 30
Impianto / Equipment :	<b>HALDEX</b>
Quantità / Qty	4

Post./Rear

Models **MIDLUM Dxi**

CEI no.

**189.526**

O.E.M. Ref

50 10 216 548

50 00 792 539

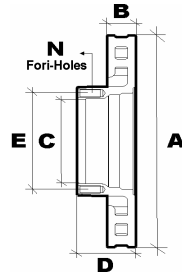

*Misure / Sizes*

<b>A</b>	<b>440 mm</b>
<b>B</b>	<b>44,5 mm</b>
<b>C</b>	<b>131 mm</b>
<b>D</b>	<b>100 mm</b>
<b>E</b>	<b>165 mm</b>
<b>N</b>	<b>10</b>



CEI no.

**584.094**

O.E.M. Ref

50 00 297 198

50 01 822 987



**WVA 29043**

**29050**

**29051**

*Misure / Sizes*

**204 x 97 x 24**

*Impianto / Equipment :*

**MERITOR**

*Quantità / Qty*

**4**

**Models "R" Series - MAGNUM**

"R" Fino al / Up to 1992 and "R" Dal / Since 1993

MAGNUM 380 / 385 / 420 / 500 / 520 Fino al / Up to 1996

**Anter./ Front**

CEI no.

**215.017**

O.E.M. Ref  
50 10 216 437

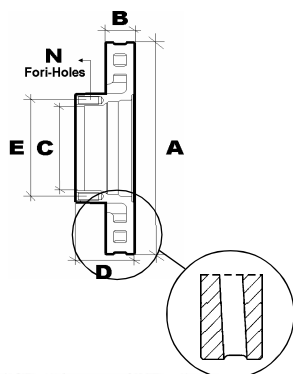

**Misure / Sizes**

<b>A</b>	<b>438 mm</b>
<b>B</b>	<b>45 mm</b>
<b>C</b>	<b>131 mm</b>
<b>D</b>	<b>97 mm</b>
<b>E</b>	<b>165 mm</b>
<b>N</b>	<b>10</b>



**Tipo di ventilazione**  
**Type of ventilation**

CEI no.

**584.021**

O.E.M. Ref  
50 01 863 904  
50 01 855 646

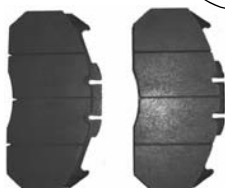

**WVA 29131 29156**

**Misure / Sizes 249,3 x 117,9 x 29,8**

**Impianto / Equipment : MERITOR**

**Quantità / Qty 4**

CEI no.

**584.095**

O.E.M. Ref  
50 01 865 750



**WVA**

**Misure / Sizes 250 x 114 x 28**

**Impianto / Equipment :**

**Quantità / Qty 4**

**584.024**

O.E.M. Ref  
50 01 833 161  
50 01 833 114



**WVA 29090**

**Misure / Sizes 249 x 114,4 x 28**

**Impianto / Equipment : MERITOR**

**Quantità / Qty 4+KIT**

**Models PREMIUM - MAGNUM**

**PREMIUM**

**MAGNUM 380 / 385 / 390 / 420 / 430 / 470 / 500 / 520 / 560 Dal / Since 1996**

**Vecchio disegno - Old design**

**Anter./ Front**

CEI no.

**215.053**

O.E.M. Ref

50 10 422 593

50 10 422 363

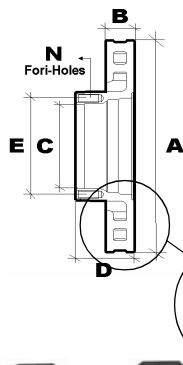

Misure / Sizes

A	434 mm
B	45 mm
C	131 mm
D	97 mm
E	165 mm
N	10



Ultimo tipo di ventilazione  
Latest type of ventilation

CEI no.

**584.021**

O.E.M. Ref

50 01 863 904

50 01 855 646

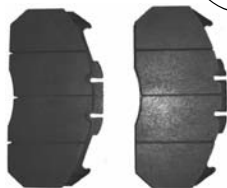

**WVA 29131 29156**

Misure / Sizes 249,3 x 117,9 x 29,8

Impianto / Equipment : **MERITOR**

Quantità / Qty 4

CEI no.

**584.095**

O.E.M. Ref

50 01 865 750



**WVA**

Misure / Sizes 250 x 114 x 28

Impianto / Equipment :

Quantità / Qty 4

**584.024**

O.E.M. Ref

50 01 833 161

50 01 833 114



**WVA 29090**

Misure / Sizes 249 x 114,4 x 28

Impianto / Equipment : **MERITOR**

Quantità / Qty 4+KIT

**Models PREMIUM - MAGNUM**

**PREMIUM**

**MAGNUM 380 / 385 / 390 / 420 / 430 / 470 / 500 / 520 / 560 Dal / Since 1996**

**Nuovo Disegno - Progetto MERITOR / New Design - MERITOR Project**

**Anter./ Front**



CEI no.

**215.105**

O.E.M. Ref  
50 10 422 364

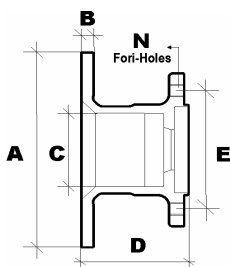

Misure / Sizes

A	434 mm
B	45 mm
C	224 mm
D	160 mm
E	256 mm
N	12



CEI no.

**584.021**

O.E.M. Ref  
50 01 863 904  
50 01 855 646

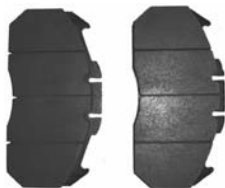

**WVA 29131 29156**

Misure / Sizes 249,3 x 117,9 x 29,8

Impianto / Equipment : **MERITOR**

Quantità / Qty 4

**Models PREMIUM - MAGNUM**

PREMIUM

**Post./Rear**

MAGNUM 380 / 385 / 420 / 500 / 520 Dal / Since 1996 (1a Versione / 1st Version)

CEI no.

215.211

O.E.M. Ref  
50 10 525 326

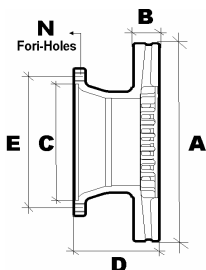

Misure / Sizes

A	434 mm
B	45 mm
C	260 mm
D	163 mm
E	335 mm
N	10



CEI no.

**584.021**

O.E.M. Ref  
50 01 863 904  
50 01 855 646

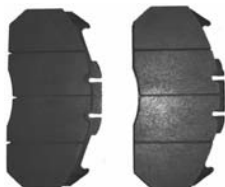

**WVA 29131 29156**

Misure / Sizes 249,3 x 117,9 x 29,8

Impianto / Equipment : **MERITOR**

Quantità / Qty 4

**Models PREMIUM - MAGNUM**

PREMIUM Dal / Since 2000 Al / To 2005

**Post./Rear**

MAGNUM 400 / 440 / 480 Dal / Since 2000 (2a Versione / 2nd Version)

CEI no.

O.E.M. Ref  
50 01 864 498

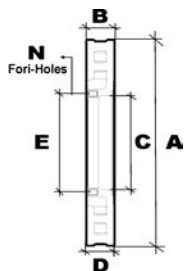

Misure / Sizes

A	434 mm
B	45 mm
C	220,2 mm
D	45 mm
E	
N	8



CEI no.

**584.041**

O.E.M. Ref  
50 01 864 363  
50 01 864 364

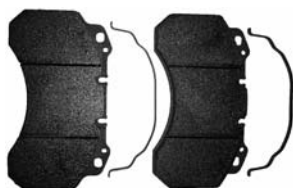

**WVA 29174 29219**

Misure / Sizes

249,6 x 106,9 x 29,2

Impianto / Equipment :

**MERITOR**

Quantità / Qty

4 + MOLLE / SPRINGS

**Anter e Post**  
**Front and Rear**

Models **PREMIUM Dxi - MAGNUM Dxi**

CEI no.

O.E.M. Ref  
S50 01 864 498

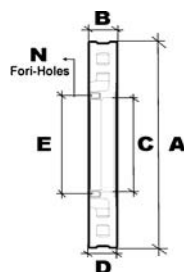

Misure / Sizes

A	434 mm
B	45 mm
C	220,2 mm
D	45 mm
E	
N	8



CEI no.

**584.041**

O.E.M. Ref  
50 01 864 363  
50 01 864 364

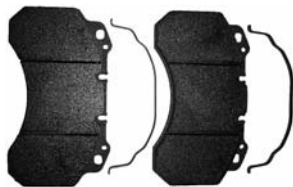

**WVA 29174 29219**

Misure / Sizes

249,6 x 106,9 x 29,2

Impianto / Equipment :

**MERITOR**

Quantità / Qty

4 + MOLLE / SPRINGS

**Anter e Post**  
**Front and Rear**

Models **PREMIUM Dxi - MAGNUM Dxi**