



MIRACLES OF HIGH FIDELITY

400.150

MERCEDES

Aluminum Gearboxes

Models

G211-16/17,0-1,0

Date

01/2004

File

MBA0014.Pdf

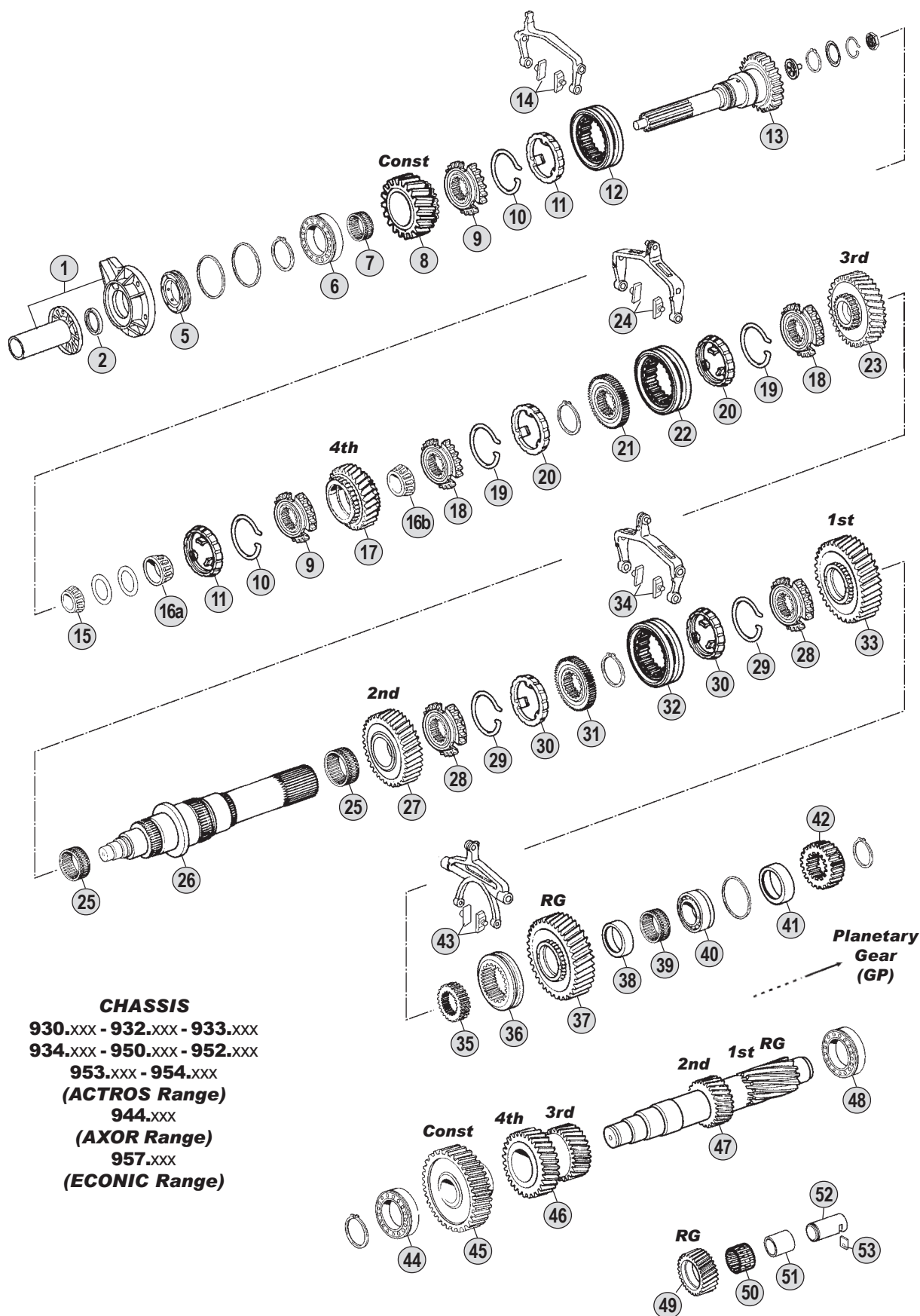

HIGH FIDELITY SPARE PARTS

Suitable To: **MERCEDES****Gearbox Models**
G211 (16 Speeds)**CHASSIS**

930.XXX - 932.XXX - 933.XXX

934.XXX - 950.XXX - 952.XXX

953.XXX - 954.XXX
(ACTROS Range)944.XXX
(AXOR Range)957.XXX
(ECONIC Range)**Models****G211 - 16 / 17,03 - 1,00** 715.510-516

All original equipment manufacturers' numbers, symbols, pictures, models and description used in this catalogue are for reference only, and it is not implied that any part listed is the product of these manufactures. Tutti i nostri particolari non sono originali ma con essi intercambiabili. I riferimenti originali, le figure, i modelli sono esposti a semplice titolo indicativo. La nostra produzione riporta il nostro marchio.

Fig.	CEI no.	MB no.	Description	Q.ty	Note					
1	135.134	945 261 1118	Front cover	1		●				
2	139.556	019 997 0547	Oil seal	1		●				
5	139.555	389 261 0665	Ring	1		●				
6	130.550	011 981 1305	Bearing	1		●				
7	137.189	018 981 6410	Needle bearing	1		●				
8	145.618	945 262 4510	Constant gear 27 T	1		●				
9	109.335	945 262 0334	Synchronizer flange	2		●				
10	111.204	387 262 1093	Spap ring	2		●				
11	119.112	389 262 0637	Synchronizer cone	2		●				
12	154.221	945 262 0323	Sliding sleeve	1		●				
13	102.282	945 262 3201	Input shaft	1		●				
13	102.280	945 262 6701	Input shaft	1		●				
13	102.279	945 262 1901	Input shaft	1	With NMV (Clutch PTO)	●				
13	102.281	945 262 5401	Input shaft	1	With NMV (Clutch PTO)	●				
13	102.278	389 262 7901	Input shaft	1	With NMV (Clutch PTO)	●				
14	141.165	389 265 2749	Slide	2		●				
15	130.556	014 981 1905	Bearing D.50x32	1		●				
16a	130.561	015 981 2005	Bearing	1		●				
16b	130.547	014 981 1605	Bearing D.50x24	1		●				
17	145.586	945 262 0510	Gear 4th Speed 29 T	1	Shot Peened Treatment	●				
17	145.623	945 262 2310	Gear 4th Speed 29 T	1	Shot Blasted Treatment	●				
18	109.189	945 262 0534	Synchronizer flange	2		●				
19	111.205	387 262 0893	Spap ring	2		●				
20	119.161	389 262 0737	Synchronizer cone	2		●				
21	157.556	389 262 4735	Synchronizer hub	1		●				
22	154.220	945 262 0423	Sliding sleeve	1		●				
23	145.591	945 262 3513	Gear 3th Speed 34 T	1		●				
24	141.165	389 265 2749	Slide	2		●				
25	137.177	018 981 6610	Needle cage	2		●				
26	103.149	945 262 3605	Main shaft	1		●				
27	145.615	389 262 2512	Gear 2nd Speed 39 T	1		●				
28	109.187	945 262 0434	Synchronizer flange	2		●				
29	111.205	387 262 0893	Spap ring	2		●				
30	119.161	389 262 0737	Synchronizer cone	2		●				
31	157.557	389 262 2535	Synchronizer hub	1		●				
32	154.220	945 262 0423	Sliding sleeve	1		●				
33	145.616	389 262 2711	Gear 1st Speed 44 T	1		●				
34	141.165	389 265 2749	Slide	2		●				
35	157.603	389 262 0135	Synchronizer hub	1	With Sleeve 389 262 1723	●				
35	157.606	389 262 3935	Synchronizer hub	1	With Sleeve 389 262 1823	●				
36	154.224	389 262 1723	Sliding sleeve	1	With Rev. Gear 389 262 2033	●				
36	154.223	389 262 1823	Sliding sleeve	1	With Rev. Gear 389 262 2133	●				
37	147.161	389 262 2033	Reverse gear 40 T	1	With Sleeve 389 262 1723	●				
37	147.163	389 262 2133	Reverse gear 40 T	1	With Sleeve 389 262 1823	●				
38	117.327	389 262 1650	Bush	1		●				

Notes

Date

01 / 2004

Table

014/A

All original equipment manufacturers' numbers, symbols, pictures and description used in this catalogue are for reference only, and it is not implied that any part listed is the product of these manufactures.
Tutti i nostri particolari non sono originali ma con essi intercambiabili. I riferimenti originali, le figure, i modelli sono esposti a semplice titolo indicativo. La nostra produzione riporta il nostro marchio.

Fig.	CEI no.	MB no.	Description	Q.ty	Note					
39	137.187	009 981 1510	Needle cage	1		●				
40	130.552	012 981 9305	Bearing D.60x130x30	1		●				
41	117.325	389 262 3754	Spacer S.18,00 mm	1		●				
42	157.605	389 262 0809	Sun gear 25 T	1		●				
43	141.160	945 265 0149	Slide	2		●				
44	130.554	014 981 1405	Bearing	1		●				
45	146.504	945 263 1110	Costant gear 38 T	1		●				
46	143.102	945 263 1013	Double gear 4th-3rd Sp. 34-27 T	1		●				
47	105.132	389 263 2502	Countershaft 21-16 T	1		●				
48	130.553	012 981 9205	Bearing	1		●				
49	147.162	389 263 1031	Reverse gear	1		●				
50	137.181	012 981 8910	Needle cage	1		●				
51	117.324	389 263 0850	Bush	1		●				
52	107.174	976 263 0030	Reverse shaft	1		●				
53		945 263 0041	Key	1		●				

All original equipment manufacturer's numbers, symbols, pictures, models and description used in this catalogue are for reference only, and it is not implied that any part listed is the product of these manufactures.
Tutti i nostri particolari non sono originali ma con essi intercambiabili. I riferimenti originali, le figure, i modelli sono esposti a semplice titolo indicativo. La nostra produzione riporta il nostro marchio.

Notes

Date

01 / 2004

Table

014/A

Suitable To: **MERCEDES**

Gearbox Models
G211 (16 Speeds)

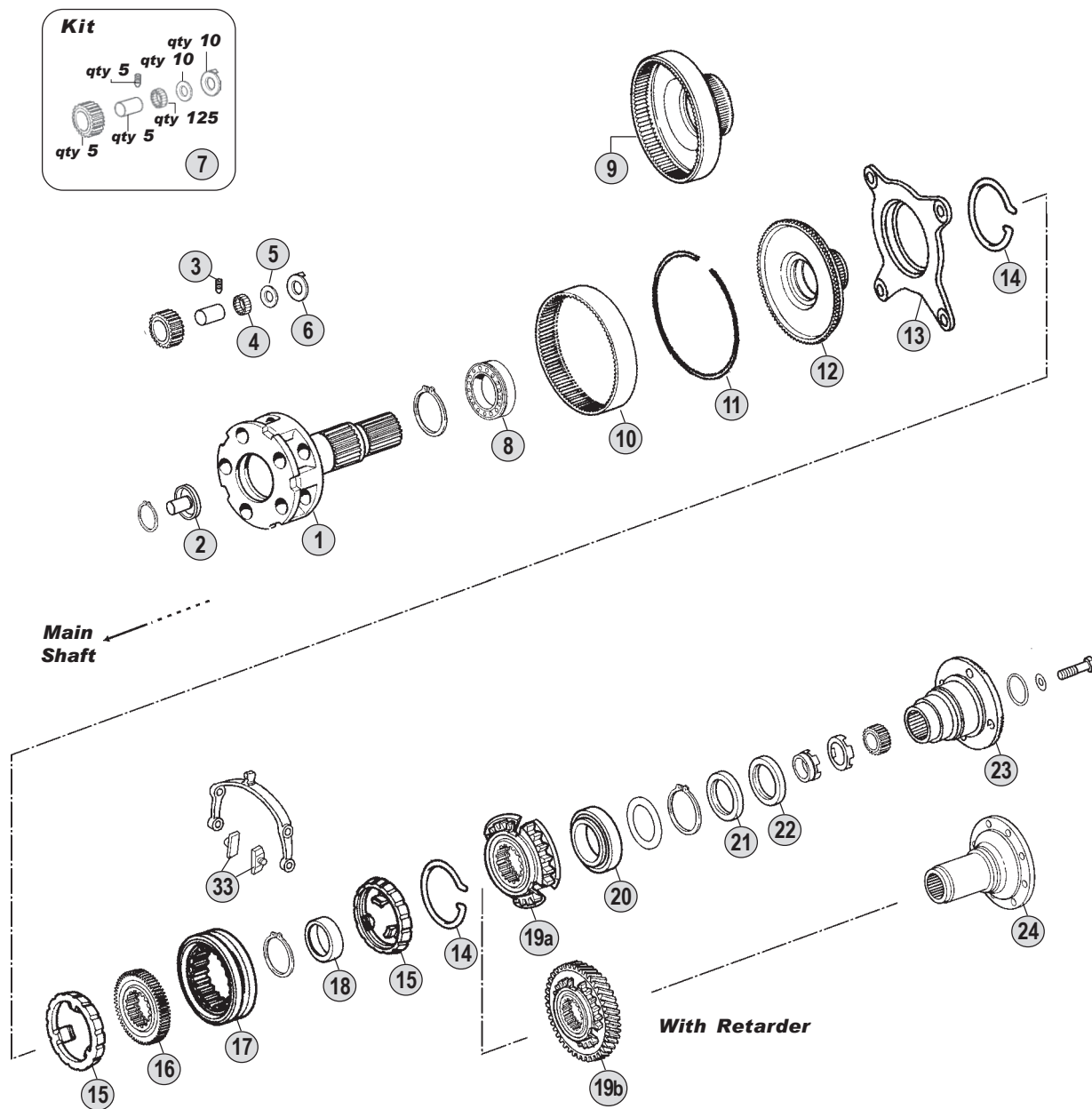

CHASSIS

930.XXX - 932.XXX - 933.XXX

934.XXX - 950.XXX - 952.XXX

953.XXX - 954.XXX

(ACTROS Range)

944.XXX

(AXOR Range)

957.XXX

(ECONIC Range)

Models

G211 - 16 / 17,03 - 1,00 715.510-516

All original equipment manufacturers' numbers, symbols, pictures, models and description used in this catalogue are for reference only, and it is not implied that any part listed is the product of these manufactures. Tutti i nostri particolari non sono originali ma con essi intercambiabili. I riferimenti originali, le figure, i modelli sono esposti a semplice titolo indicativo. La nostra produzione riporta il nostro marchio.

Fig.	CEI no.	MB no.	Description	Q.ty	Note					
1	190.337	945 260 4461	Planet carrier	1	Empty	●				
1	190.338	945 260 4661	Planet carrier	1	Complete	●				
2	188.181	389 269 4734	Oil tube	1		●				
3	187.609	000914 006109	Stud 6x14 mm	5		●				
4	171.057	000 981 4186	Needle	125		●				
5	169.801	389 262 0162	Thrust washer	10		●				
6	169.803	389 262 1462	Thrust washer	10		●				
7	198.886	655 260 0197	Repair kit	1		●				
8	130.540	008 981 1325	Bearing D.90x130x14	1		●				
9	123.230	945 262 0108	Crown gear 85 T	1	ALT-1 pc. Fig.10+Fig.11+Fig.12	●				
10	123.232	945 262 0208	Crown gear 85 T	1	ALT-1 pc. Fig.9 (Crown assy)	●				
11	111.209	389 262 0773	Ring	1		●				
12	150.144	389 262 1425	Flange gear	1	ALT-1 pc. Fig.9 (Crown assy)	●				
13	198.879	389 260 2036	Synchronizer flange	1		●				
14	111.206	389 262 0293	Ring	2		●				
15	119.160	389 262 0537	Synchronizer cone	2		●				
16	155.204	389 262 2035	Synchronizer hub	1		●				
17	154.217	945 262 0823	Sliding sleeve	1		●				
18	117.322	389 262 0251	Spacer	1		●				
19a	109.337	389 262 9234	Synchronizer cone	1		●				
19b	109.342	389 264 0730	Synchronizer flange	1	For model with VOITH Retarder	●				
20	130.564	008 981 3025	Bearing D.80x150x28	1		●				
20	130.563	007 981 8201	Bearing	1	For model with TELMA retarder	●				
21	139.551	013 997 7247	Oil seal	1		●				
21	139.552	013 997 7347	Oil seal	1	For model with VOITH Retarder	●				
21	139.557	015 997 6447	Oil seal	1	For model with TELMA retarder	●				
22	139.552	013 997 7347	Oil seal	1		●				
22	139.558	017 997 1247	Oil seal	1	For model with TELMA Retarder	●				
23	197.083	945 262 0045	Output flange D.180	1		●				
23	197.082	389 262 0645	Output flange D.200	1		●				
23	197.081	389 262 0545	Output flange D.180	1	For model with VOITH Retarder	●				
23	197.080	389 262 0945	Output flange D.200	1	For model with VOITH Retarder	●				
24	197.085	387 264 1945	Output flange D.198	1	For model with TELMA retarder	●				
24	197.084	945 262 0445	Output flange D.200	1	For model with TELMA retarder	●				
25	101.123	389 269 1210	Oil pump shaft	1		●				
25	101.124	389 269 1310	Oil pump shaft	1	For model with VOITH Retarder	●				
26	280.587	389 260 0690	Oil pump	1	Old Type - Assembly	●				
27	130.538	004 981 9225	Bearing D.45x75x16	1		●				
28	189.607	945 269 0101	Oil pump cover	1	New Type - Disassembled	●				
29	111.208	029 997 5748	Ring	1	New Type - Disassembled	●				
30	189.606	389 269 1406	Oil pump gear	1	New Type - Disassembled	●				
31	189.605	389 269 0706	Oil pump hub	1	New Type - Disassembled	●				
32	189.604	389 269 3801	Oil pump housing	1	New Type - Disassembled	●				
33	141.162	389 265 2449	Slide	2		●				

Notes

Date

01 / 2004

Table

014 / B

All original equipment manufacturers' numbers, symbols, pictures and description used in this catalogue are for reference only, and it is not implied that any part listed is the product of these manufactures.
Tutti i nostri particolari non sono originali ma con essi intercambiabili. I riferimenti originali, le figure, i modelli sono esposti a semplice titolo indicativo. La nostra produzione riporta il nostro marchio.